



Accessory Fitting Instructions

Expedition Aluminium Pannier Kit - Silver	
Kit Number	Models Affected
A9500880	Tiger 900, Tiger 900 GT, Tiger 900 GT Pro, Tiger 900 GT (LRH), Tiger 900 GT Aragon Edition, Tiger 900 Rally, Tiger 900 Rally Pro, Tiger 900 Rally Aragon Edition, Tiger 850 Sport
A9500820	Tiger 1200 GT, Tiger 1200 GT Pro, Tiger 1200 Rally Pro, Tiger 1200 GT Explorer, Tiger 1200 Rally Explorer
Expedition Aluminium Pannier Kit - Black	
Kit Number	Models Affected
A9500885 A9500985	Tiger 900, Tiger 900 GT, Tiger 900 GT Pro, Tiger 900 GT (LRH), Tiger 900 GT Aragon Edition, Tiger 900 Rally, Tiger 900 Rally Pro, Tiger 900 Rally Aragon Edition, Tiger 850 Sport
A9500825 A9500925	Tiger 1200 GT, Tiger 1200 GT Pro, Tiger 1200 Rally Pro, Tiger 1200 GT Explorer, Tiger 1200 Rally Explorer

Thank you for choosing this Triumph genuine accessory kit. This accessory kit is the product of Triumph's use of proven engineering, exhaustive testing, and continuous striving for superior reliability, safety and performance.

Completely read all of these instructions before commencing the installation of the accessory kit in order to become thoroughly familiar with the kit's features and the installation process.

These instructions should be considered a permanent part of your accessory kit, and should remain with it even if your accessory equipped motorcycle is subsequently sold.

Note:

- **The Accessory Pannier Kit A9500880, A9500985 and A9500885 listed above must only be used in conjunction with the Accessory Pannier Mounting Rail Kit A9501286.**
- **The Accessory Pannier Kit A9500820, A9500825 and A9500925 listed above must only be used in conjunction with the Accessory Pannier Mounting Rail Kit A9500772.**

Parts Supplied

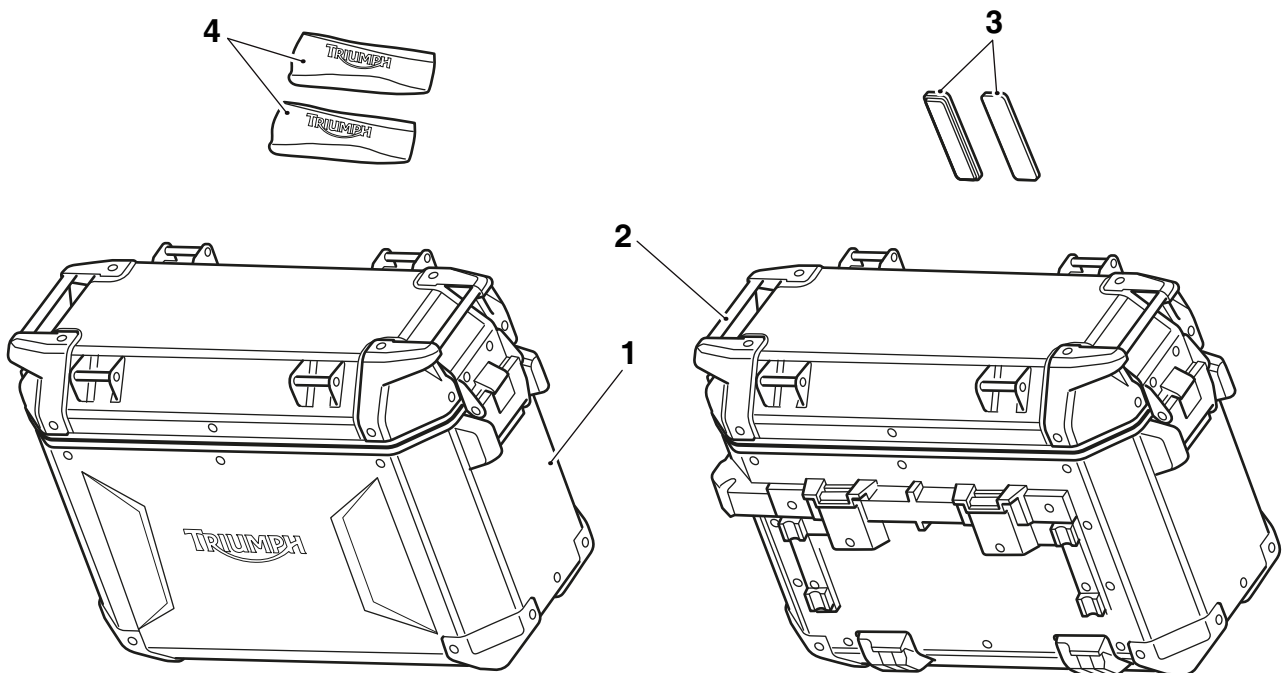

1. Pannier, right hand	1 off	3. Reflector	2 off
2. Pannier, left hand	1 off	4. Cleaning wipe	2 off

Warning

Fit only genuine Triumph accessories to those models approved by Triumph as listed in the associated Triumph fitting instructions. The accessory kits covered in this instruction are designed for use on specific models of Triumph motorcycle. The accessory kits and the models applicable are listed at the start of the instruction. They should never be fitted to any other Triumph model or to any other manufacturer's motorcycle. Fitting an accessory kit to a Triumph model not listed, or to any other manufacturer's motorcycle will affect the performance, stability and handling of the motorcycle. This may affect the rider's ability to control the motorcycle and could result in an accident causing severe injuries or death.

Warning

Always have Triumph approved parts, accessories and conversions fitted by a trained technician of an authorised Triumph dealer. The fitment of parts, accessories and conversions by a technician who is not of an authorised Triumph dealer may affect the handling, stability or other aspects of the motorcycle's operation which may result in loss of motorcycle control and an accident.

Warning

Make sure the motorcycle is supported. A correctly supported motorcycle will help prevent it from falling. An unstable motorcycle may fall, causing injury to the operator or damage to the motorcycle.

Note:

- Triumph offers a broad range of approved genuine accessories for your motorcycle. We cannot therefore cover all possible equipment variations in these instructions. For removal and installation of Triumph Genuine Accessories always refer to the instructions supplied with the respective accessory kit. To obtain additional copies of any Triumph accessory instructions, visit www.triumphinstructions.com or contact your authorised Triumph dealer.

Models Fitted with Rear Side Reflectors

Caution

When fitting self-adhesive parts care must be taken to make sure positioning is correct and accurate. Once the adhesive has been attached to the mounting surface, there is no satisfactory method of removal or re-positioning if incorrectly aligned. Initial bonding is instant, full bonding is achieved after 72 hours.

Notice

Failure to fit a reflector to each pannier as shown may contravene the law of your country, state or territory. This will render the motorcycle illegal for road use where such laws apply. Always fit reflectors as shown.

Notice

Do not fit a reflector to each pannier in Japan as this will contravene Japanese law and render the motorcycle illegal for road use.

- Read the warning notices printed on the cleaning wipe packet.
- The surface to which the reflector is affixed must be clean and dry to make sure that the adhesive has a sound base to adhere to. Use the cleaning wipe supplied for this purpose.

1. Using the cleaning wipes provided, clean the area of both panniers prior to fastening each reflector, as shown below.

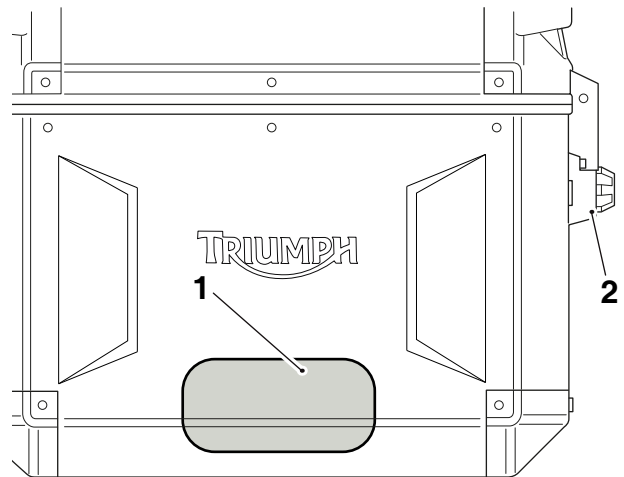

1. Cleaning area
2. Pannier lock

2. Peel the protective film from the back of each reflector.
3. Fit one reflector to each pannier, in the position shown, making sure the surface of the pannier is clean and free from grease.

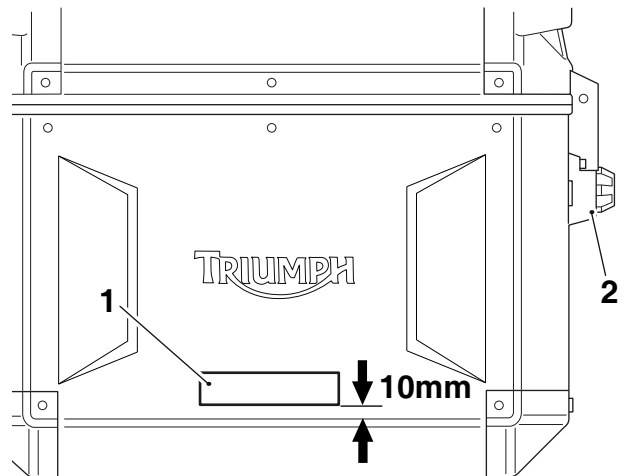

1. Reflector
2. Pannier lock

Lock Barrel Fitment

1. Take a lock barrel (supplied with the motorcycle). Align the tumblers to the slot and push the barrel into position until it clicks into place.

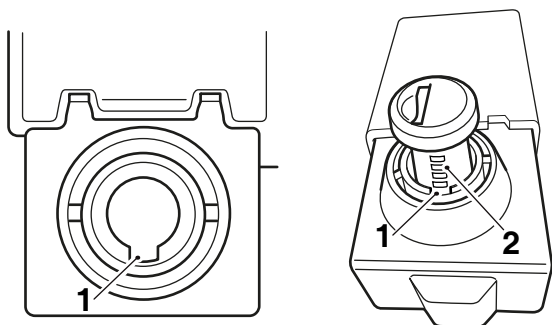

1. Slot
2. Tumblers

Note:

- **The lock barrel will only fit one way.**
2. Check the operation of the lock barrel.
 3. Fit a lock barrel to the remaining pannier in the same manner.

Fitting the Expedition Aluminium Panniers

Note:

- **The same procedure can be followed to remove and mount the left hand or the right hand panniers.**

1. The pannier lock barrel has two positions, as shown below.

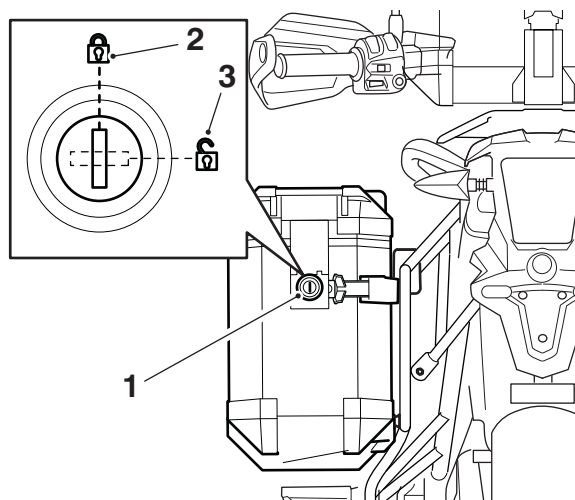

1. Lock barrel
2. Lock position
3. Unlock position

To Remove each Expedition Aluminium Pannier:

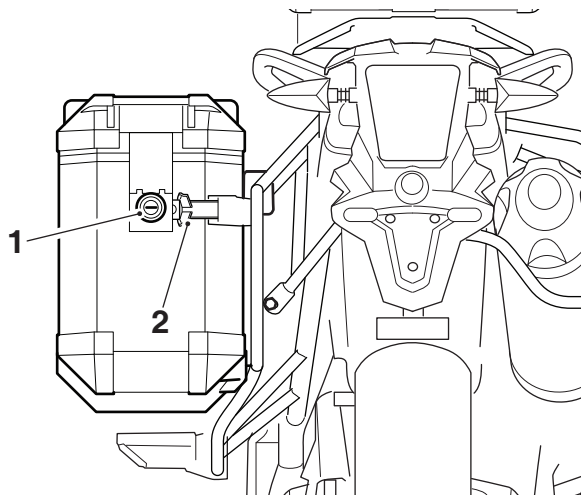

1. Lock (left hand pannier shown)
2. Locking mechanism release lever

- To unlock and remove the pannier from the pannier mountings, turn the key to the UNLOCK position. Whilst supporting the pannier, pull the locking mechanism release lever to detach the pannier from the upper mounting points, then lift the pannier free from the lower mounting points.

To Install each Expedition Aluminium Pannier:

- Insert the key into the lock. Turn the key to the UNLOCK position.

Note:

- The left hand and right hand panniers must be mounted to the correct side of the motorcycle. When mounting the panniers, make sure that the lock barrels are facing towards the rear of the motorcycle.
- Position the pannier onto the lower pannier mounting points, as shown below.

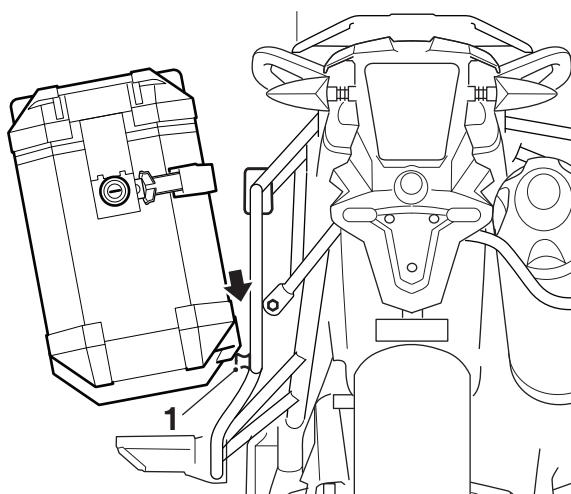

1. Lower pannier mounting point

- Locate the pannier's locking mechanism to the upper mounting points and press the pannier inwards to engage the locking mechanism.

Note:

- An audible click can be heard when the pannier's upper mounting locking mechanism is engaged.
- Two status indicators are also provided on the top of the upper mounting point. The status indicators will change colour from red to green when the locking mechanism is correctly engaged.
- If any red remains visible in the status indicators, the upper mounting locking mechanism is not correctly engaged.

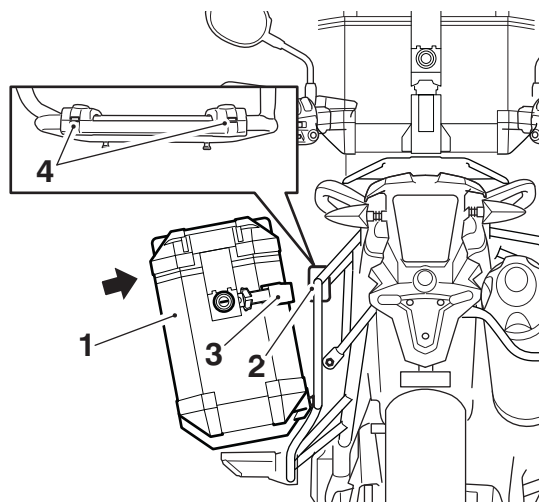

- Pannier
- Upper mounting point
- Locking mechanism
- Status indicators

- Lock the pannier to the rail by turning the key to the LOCK position. Remove the key.

Warning

An incorrectly mounted pannier may detach whilst riding, resulting in a dangerous riding condition.

Before riding, always make sure that both panniers are mounted correctly. Make sure that the status indicators located on the top of the pannier's upper mounting points display only green, the lock barrel is turned to the LOCK position and the key removed.

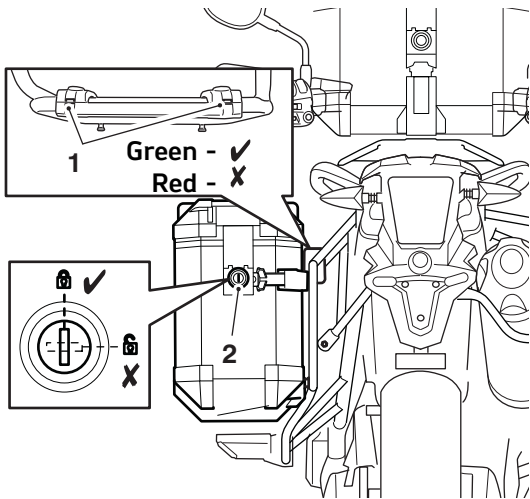

- 1. Locking mechanism status indicators
- 2. Lock barrel

A pannier that detaches whilst riding may cause loss of motorcycle control and an accident and/or injury to other road users.

Pannier Operation

1. To unlock and open the pannier, insert the key and turn it to the UNLOCK position, then release the pannier lid latch. The lid can then be opened.

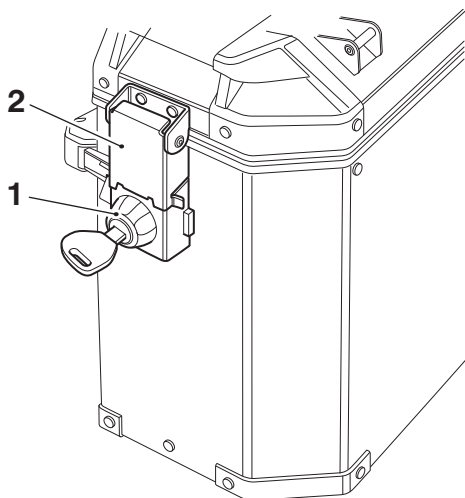

- 1. Lock barrel - unlock position
- 2. Pannier lid latch

2. The lid can also be removed from the pannier. To remove the lid, detach the retaining straps, as shown below.

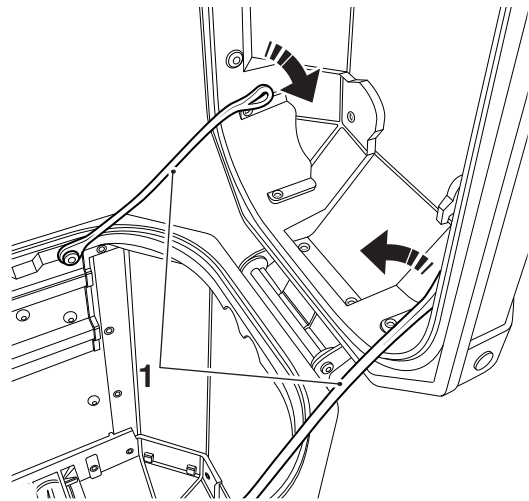

- 1. Retaining straps

3. Press downwards on the quick-release mechanism for the pannier lid hinge. Slide the lid down and to the rear to release the pannier lid hinge. The lid can now be removed from the pannier.

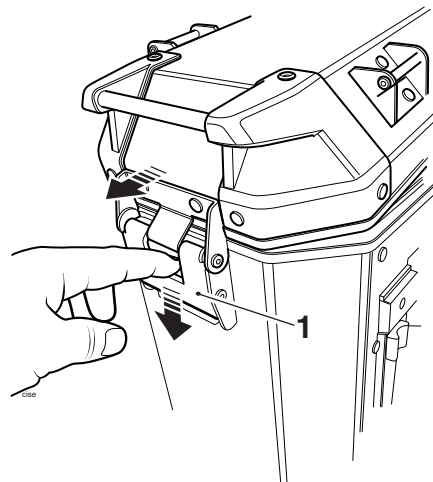

- 1. Pannier lid hinge quick-release mechanism

4. To install the pannier lid, press downwards on the quick-release mechanism and relocate the pannier lid hinge. Release the quick-release mechanism, making sure that the hinge is correctly engaged. Attach the retaining straps to the pannier lid.

- To close and lock the pannier, close the lid and secure with the pannier lid latch. Turn the key to the LOCK position and remove it.

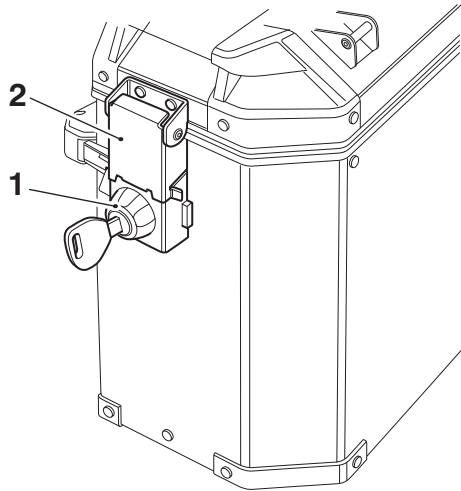

- Lock barrel - lock position
- Pannier lid latch

- Remove the motorcycle from the paddock stand and place on the side stand.

Pannier Lock Barrel Replacement

Pannier Latch Housing Removal

- Open the pannier lid and locate the six screws retaining the pannier latch housing to the pannier. Remove the six screws and washers and remove the pannier latch housing from the pannier. Retain the screws and washers for reuse.

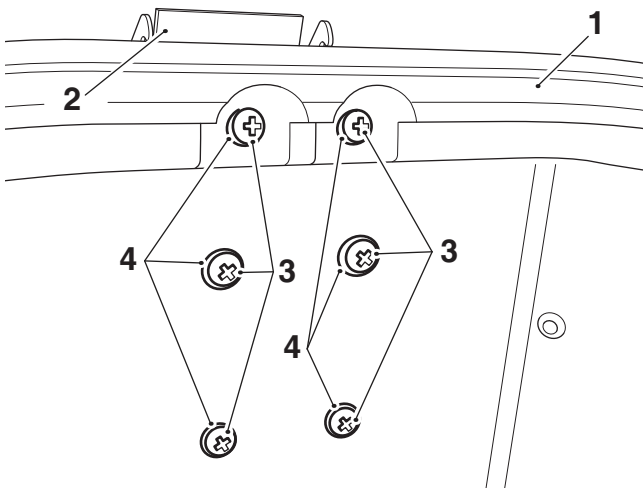

- Pannier
- Pannier latch housing
- Fixings
- Washers

- Remove the locking cursor from the pannier latch housing, left hand shown. Retain the locking cursor for reuse.

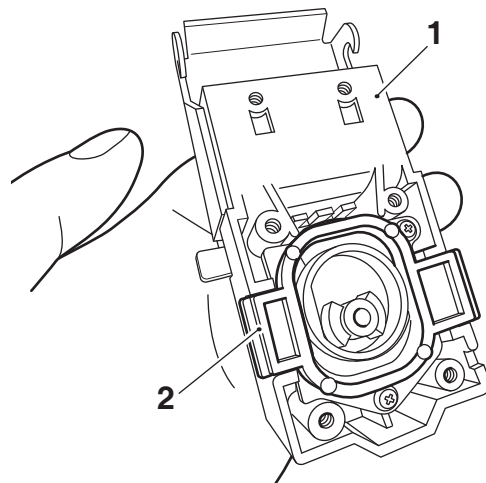

- Pannier latch housing
- Locking cursor

- Remove the retaining plate from the pannier latch housing. Retain the fixings and retaining plate for reuse.

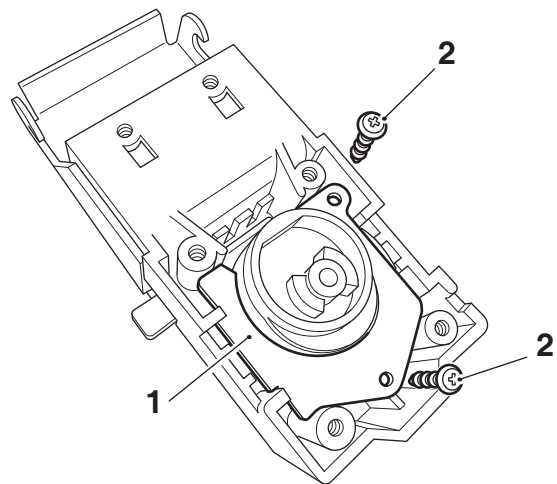

- Retaining plate
- Fixings

- Make sure the cam is in the unlocked position with the locking section of the cam in the orientation shown.

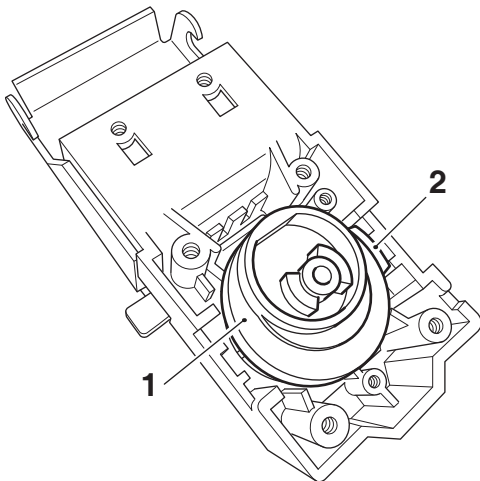

- Cam
- Locking section

- Lift and remove the cam from the pannier latch housing making sure the ball bearing and spring do not become separated from the pannier latch housing. Retain the cam for reuse.

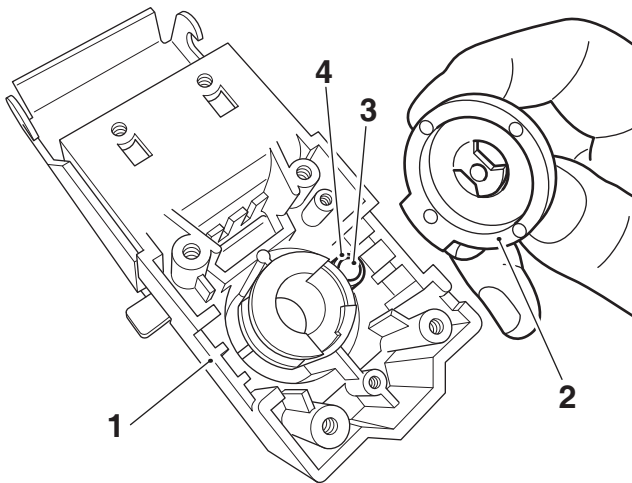

- Pannier latch housing
- Cam
- Ball bearing
- Spring

Note:

- Make sure the key is inserted into the lock barrel prior to removing the lock barrel from the lock assembly.
- Press the retaining lock pin into the lock barrel and remove the lock barrel from the front of the pannier latch housing.

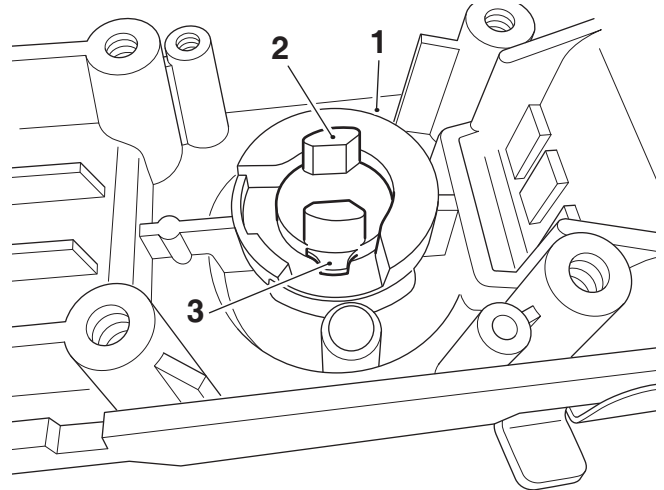

- Pannier latch housing
- Lock barrel
- Retaining lock pin

Pannier Latch Housing Fitment

- Making sure the ball bearing remains correctly located in the pannier latch housing, refit the cam in the locked position with the locking section of the cam in the orientation shown.

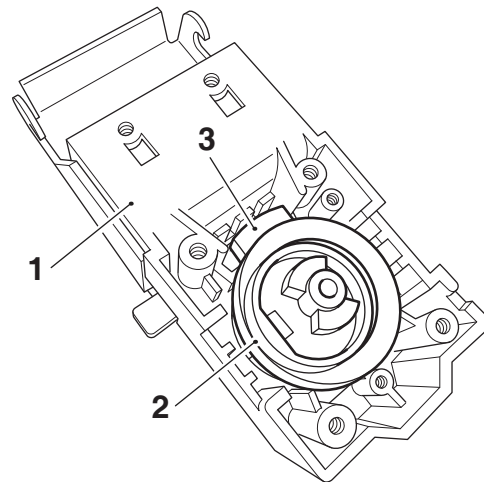

- Pannier latch housing
- Cam
- Locking section

- Refit the retaining plate on to the pannier latch housing and secure with the original fixings. Tighten the fixings to **1 Nm**.

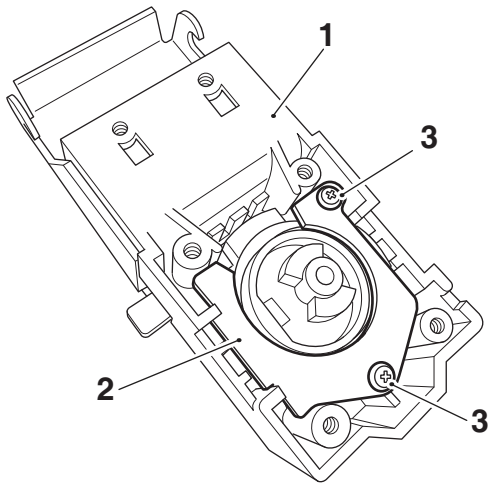

- Pannier latch housing
- Retaining plate
- Fixings

- Refit the locking cursor over the cam onto the pannier latch housing, left hand shown.

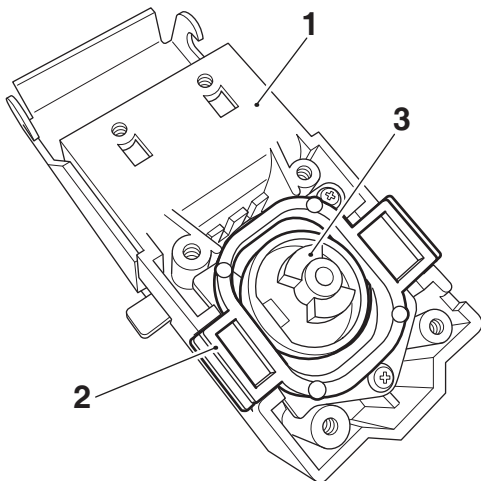

- Pannier latch housing
- Locking cursor
- Cam

- Refit the pannier latch housing to the pannier using the original fixings and washers. Tighten the fixings to **1 Nm**.

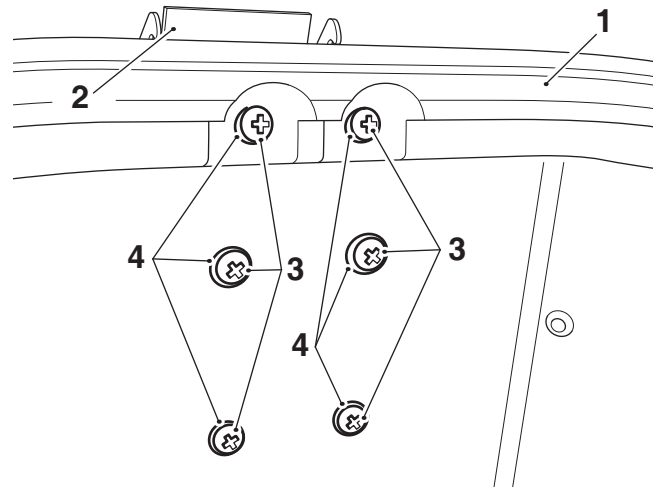

- Pannier
- Pannier latch housing
- Fixings
- Washers

- Fit the lock barrel referring to the Lock Barrel Fitment section on page 4 of this instruction.

Tiger 900 and Tiger 850 models only



Warning

The maximum safe load for each pannier is 5 kg (11 lbs). Never exceed this loading limit as this may cause the motorcycle to become unstable leading to loss of motorcycle control and an accident.

Tiger 1200 models only



Warning

The maximum safe load for each pannier is 7.5 kg (16.5 lbs). Never exceed this loading limit as this may cause the motorcycle to become unstable leading to loss of motorcycle control and an accident.

All models



Warning

The Expedition Aluminium Panniers are designed to be fitted as a pair. Never ride the motorcycle with only one pannier installed. Riding the motorcycle with one pannier installed may cause the motorcycle to become unstable leading to loss of motorcycle control and an accident.



Warning

After fitting or removing the panniers, operate the motorcycle in a safe area free from traffic to gain familiarity with the new handling characteristics. Operation when not familiar with the new characteristics of the motorcycle may result in loss of motorcycle control and an accident.



Warning

Incorrect loading may result in an unsafe riding condition leading to loss of motorcycle control and an accident.

Always make sure any loads carried are evenly distributed on both sides of the motorcycle. Make sure that the load is correctly secured such that it will not move around while the motorcycle is in motion.

Evenly distribute the load within each pannier. Pack heavy items at the bottom and on the inboard side of the pannier.

Always check the load security regularly (though not while the motorcycle is in motion) and make sure that the load does not extend beyond the rear of the motorcycle. Never exceed the maximum vehicle loading weight. Refer to the Owner's Handbook for the maximum loading weight specification.

This maximum loading weight is made up from the combined weight of the rider, passenger, any accessories fitted and any load carried.

For models that have adjustable suspension settings, make sure that front and rear spring preload and damping settings are suitable for the loading condition of the motorcycle. Refer to the Owner's Handbook.

Note the maximum permissible payload for the panniers is stated on a label inside the pannier.

Release Lever Mechanism Cleaning and Lubrication

With extended use, dirt may gather in the pannier release mechanism, resulting in a stiff mechanism and difficulty removing the panniers. The mechanism can be disassembled, cleaned and lubricated, as shown below. The process is the same for the left hand and right hand panniers. The right hand pannier is shown.

1. Remove the 12 fixings shown from the inside of the pannier. Retain for reuse.

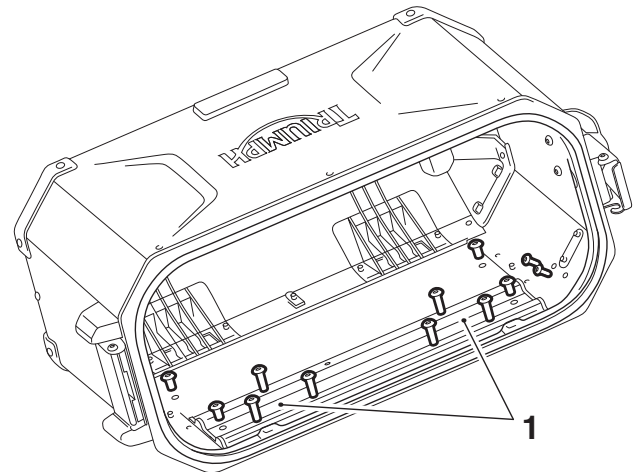

1. Fixings

2. Remove the black release mechanism cover and the hook assembly. Retain for reuse.

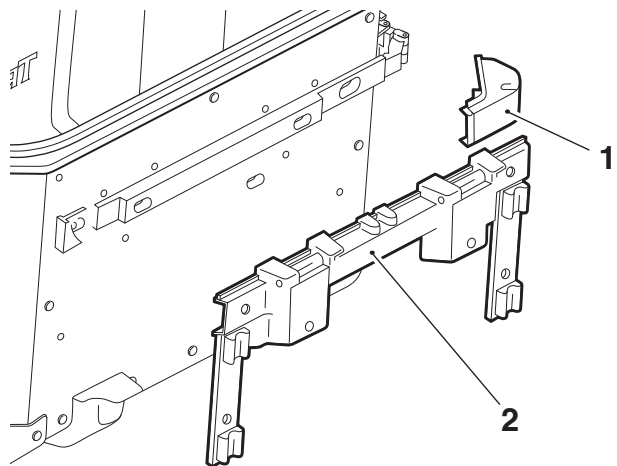

1. Release mechanism cover

2. Hook assembly

3. Clean any dirt or debris from the release mechanism and from the hook assembly.

- If required, lubricate the hinge and spring of the release mechanism using aluminium grease.

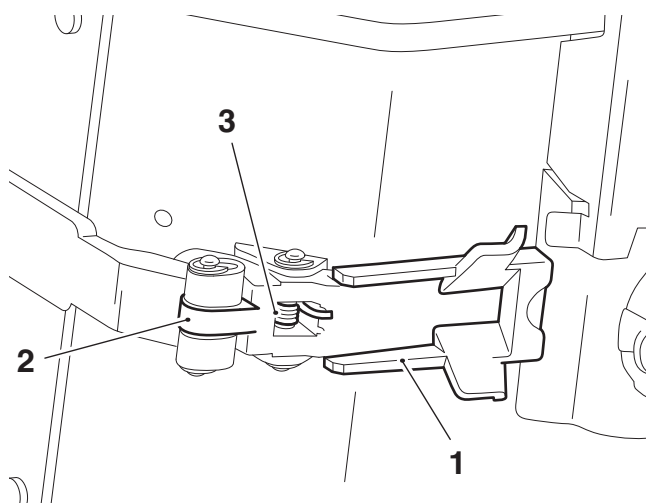

- Release mechanism
- Hinge
- Spring

- If required, lubricate the 4 springs within the hook assembly using aluminium grease.

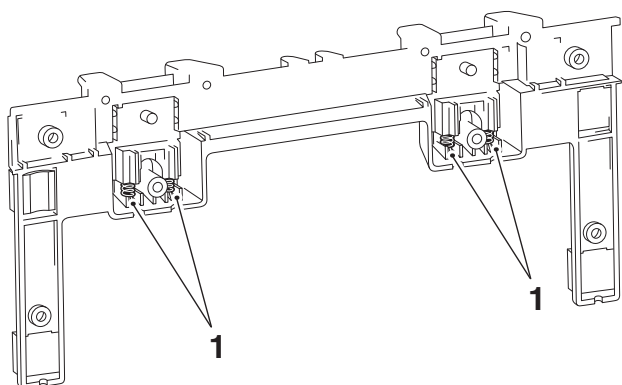

1. Hook assembly springs

- Refit the hook assembly and release mechanism cover, using the original fixings. Tighten to **1 Nm**.

Replacement Tyres

Note:

- A list of approved tyres specific to these models is available from your authorised Triumph dealer, or on the internet at www.triumph.co.uk.

 Warning
<p>Use the recommended tyres ONLY in the combinations given. Do not mix tyres from different manufacturers or mix different specification tyres from the same manufacturers as this may result in loss of motorcycle control and an accident.</p>

Cleaning the Luggage System

All parts of the luggage system fitted to your motorcycle must be cleaned regularly to avoid a deterioration of their appearance.

Washing

Prepare a mixture of cold water and mild automotive cleaner. Do not use a highly alkaline soap as commonly found at commercial car washes because it leaves a residue.

Wash the luggage system with a soft cloth. Do not use an abrasive scouring pad or steel wool. They will damage the finish.

Rinse the luggage system thoroughly.

Make sure no soap or water enters the inside compartment.

Dry the luggage system as far as possible with a soft cloth.

Protecting

When the luggage system is dry, protect with a colourless lubricating spray.

 Caution
<p>The use of abrasive cleaners and polishes will damage the system and must not be used.</p>

It is recommended that regular protection be applied to the system as this will both protect and enhance the system's appearance.

Note:

- It is recommended to use the Triumph inner bags to protect both the luggage contents and the inner surfaces of the luggage.

 **Warning**

Never ride an accessory-equipped motorcycle, or a motorcycle carrying a payload of any kind, at speeds above 80 mph (130 km/h). In either/both of these conditions, speeds in excess of 80 mph (130 km/h) should not be attempted even where the legal speed limit permits this.

The presence of accessories and/or payload will cause changes in the stability and handling of the motorcycle.

Failure to allow for changes in motorcycle stability may lead to loss of motorcycle control or an accident.

When riding at high speed, always be aware that various motorcycle configurations and environmental factors can adversely affect the stability of your motorcycle. For example:

- Incorrectly balanced loads on both sides of the motorcycle
- Incorrectly adjusted front and rear suspension settings
- Incorrectly adjusted tyre pressures
- Excessively or unevenly worn tyres
- Side winds and turbulence from other vehicles
- Loose clothing.

Remember that the 80 mph (130 km/h) absolute limit will reduce by the fitting of non-approved accessories, incorrect loading, worn tyres, overall motorcycle condition and poor road or weather conditions.

 **Warning**

If, after fitment of this accessory kit, you have any doubt about the performance of any aspect of the motorcycle, contact an authorised Triumph dealer and do not ride the motorcycle until the authorised dealer has declared it fit for use. Riding a motorcycle when there is any doubt as to any aspect of the performance of the motorcycle may result in loss of control of the motorcycle leading to an accident.

 **Warning**

This motorcycle must not be operated above the legal road speed limit except in authorised closed-course conditions.

 **Warning**

Only operate this Triumph motorcycle at high speed in closed-course, on-road competition or on closed-course racetracks. High-speed operation should only be attempted by riders who have been instructed in the techniques necessary for high-speed riding and are familiar with the motorcycle's characteristics in all conditions.

High-speed operation in any other circumstances is dangerous and will lead to loss of motorcycle control and an accident.

 **Warning**

Never ride an accessory equipped motorcycle at speeds above 80 mph (130 km/h).

The presence of accessories will cause changes in the stability and handling of the motorcycle. Failure to allow for changes in motorcycle stability may lead to loss of control or an accident.

Remember that the 80 mph (130 km/h) limit will be reduced by the fitting of non-approved accessories, incorrect loading, worn tyres, overall motorcycle condition and poor road or weather conditions.