



Accessory Fitting Instructions

Top Box Back Rest Pad Kit	
Kit Number	Models Affected
A9500729	Tiger 900, Tiger 900 GT, Tiger 900 GT Pro, Tiger 900 GT (LRH), Tiger 900 GT Aragon Edition, Tiger 900 Rally, Tiger 900 Rally Pro, Tiger 900 Rally Aragon Edition, Tiger 850 Sport, Tiger 1200 GT, Tiger 1200 GT Pro, Tiger 1200 Rally Pro, Tiger 1200 GT Explorer, Tiger 1200 Rally Explorer

Thank you for choosing this Triumph genuine accessory kit. This accessory kit is the product of Triumph's use of proven engineering, exhaustive testing, and continuous striving for superior reliability, safety and performance.

Completely read all of these instructions before commencing the installation of the accessory kit in order to become thoroughly familiar with the kit's features and the installation process.

These instructions should be considered a permanent part of your accessory kit, and should remain with it even if your accessory equipped motorcycle is subsequently sold.

Note:

- A9500729 can only be used in conjunction with 52L top box kits.

Parts Supplied

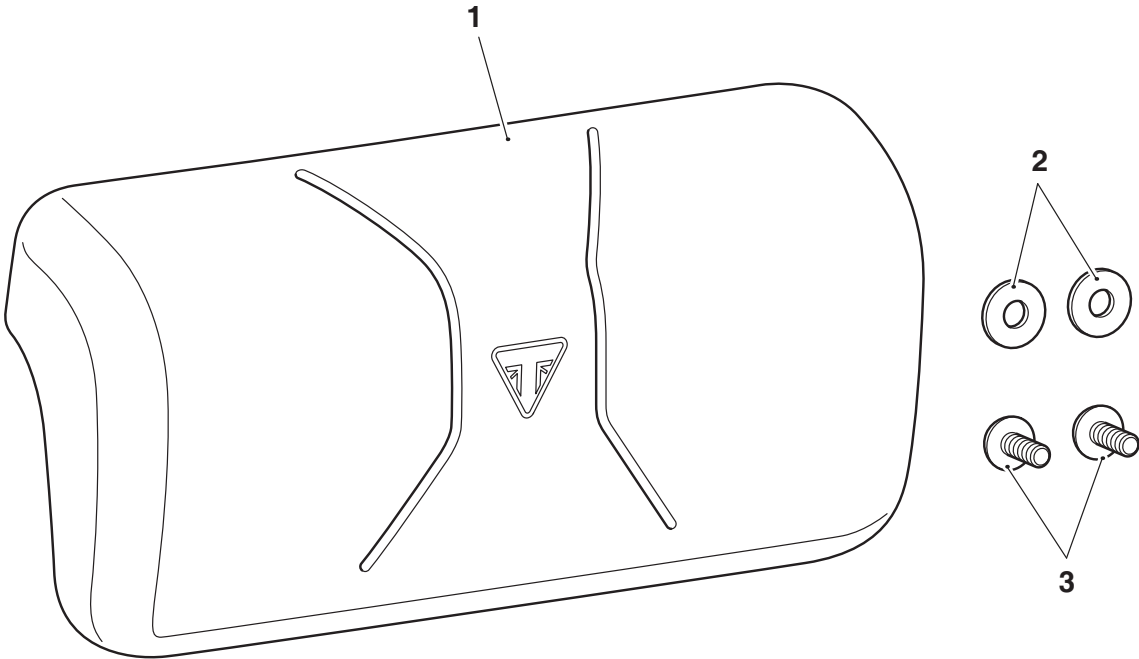

1. Back rest, pad	1 off	3. Fixing, M6 x 16 mm	2 off
2. Rubber washer	2 off		



Warning

Fit only genuine Triumph accessories to those models approved by Triumph as listed in the associated Triumph fitting instructions. The accessory kits covered in this instruction are designed for use on specific models of Triumph motorcycle. The accessory kits and the models applicable are listed at the start of the instruction. They should never be fitted to any other Triumph model or to any other manufacturer's motorcycle. Fitting an accessory kit to a Triumph model not listed, or to any other manufacturer's motorcycle will affect the performance, stability and handling of the motorcycle. This may affect the rider's ability to control the motorcycle and could result in an accident causing severe injuries or death.



Warning

Always have Triumph approved parts, accessories and conversions fitted by a trained technician of an authorised Triumph dealer. The fitment of parts, accessories and conversions by a technician who is not of an authorised Triumph dealer may affect the handling, stability or other aspects of the motorcycle's operation which may result in loss of motorcycle control and an accident.



Warning

A torque wrench of known accurate calibration must be used when fitting this accessory kit. Failure to tighten any of the fasteners to the correct torque specification may result in loss of motorcycle control and an accident.



Warning

Throughout this operation, make sure that the motorcycle is stabilised and adequately supported to prevent risk of injury from the motorcycle falling.

Note:

- Triumph offers a broad range of approved genuine accessories for your motorcycle. We cannot therefore cover all possible equipment variations in these instructions. For removal and installation of Triumph Genuine Accessories, always refer to the instructions supplied with the respective accessory kit. To obtain additional copies of any Triumph accessory instructions, visit www.triumphinstructions.com or contact your authorised Triumph dealer.

- Print off the template from the last page of this instruction and cut along dotted line.

Note:

- Measure the distance between the hole centres on the template to make sure they match the stated dimension of 140 mm.

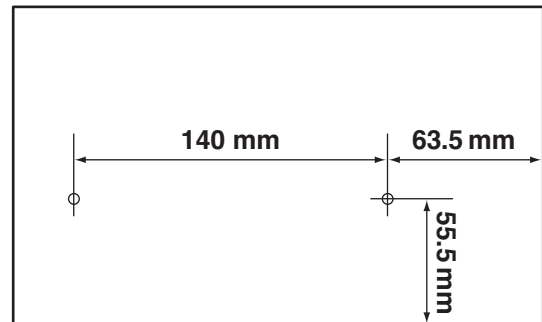

- Place the template on the front face of top box, aligning the right hand edge and bottom edge of the template with the internal edge of the top box, as shown.

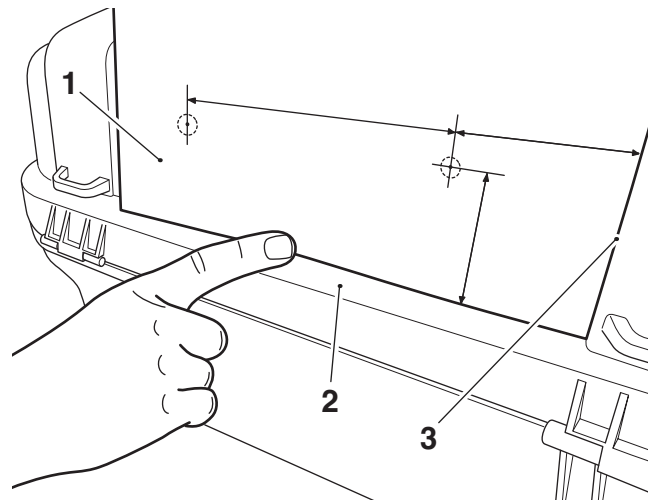

- Template
- Top box internal edge
- Right hand edge

3. Secure the template in position on the top box using masking tape along the top edge of the template.

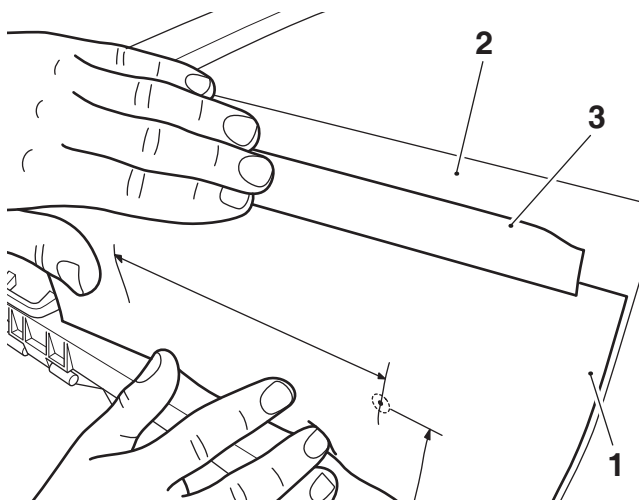

1. Template
2. Top box
3. Masking tape



Caution

Make sure the template is correctly positioned on the top box before drilling any pilot holes.

If the template is not positioned correctly on the top box drilled holes will not be in the correct position and will prevent the backrest pad from being fitted to the top box.

4. Drill a pilot hole through the top box at the centre of both fixing hole positions on the template.

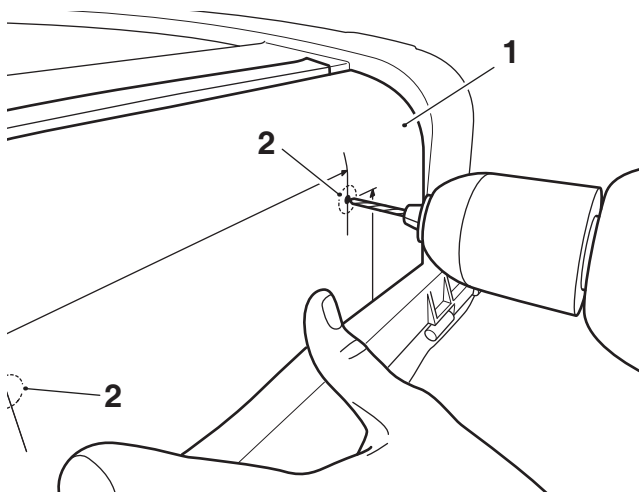

1. Template
2. Fixing holes

5. Remove the masking tape and template from the top box and drill through both pilot holes using a Ø 6.5 mm drill bit.

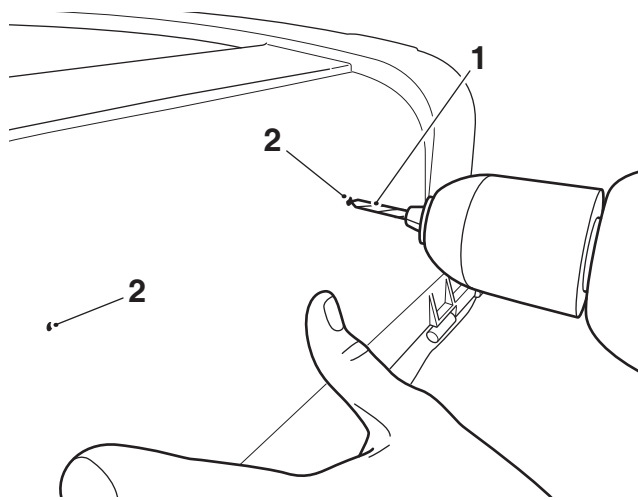

1. Drill bit, Ø 6.5 mm
2. Pilot holes

6. Collect a rubber washer and fixing from the kit.
7. From the inside of the top box align the rubber washer with one of the drilled holes and fit the fixing through the rubber washer and drilled hole.

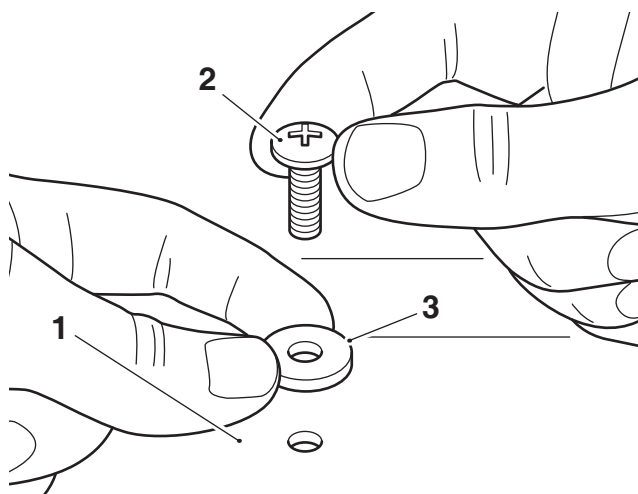

1. Top box
2. Fixing
3. Rubber washer

8. Collect the back rest pad from the kit and position it on the front face of the top box in the orientation shown. Align the back rest pad with the fixing through the top box and screw the fixing into the back rest pad. Do not fully tighten the fixing at this stage.

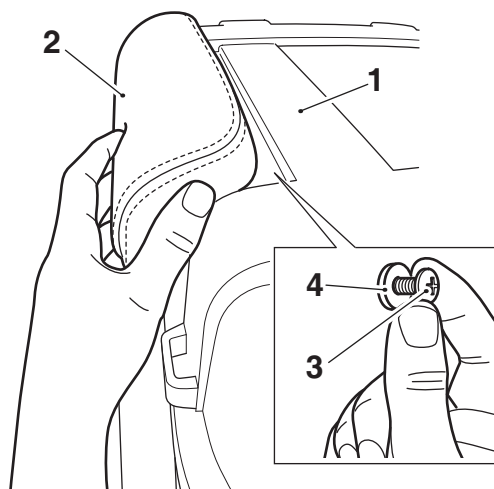

1. Top box
2. Backrest pad
3. Fixing
4. Rubber washer

9. Collect the rubber washer and fixing from the kit. From the inside of the top box align the rubber washer with the second drilled hole in the top box and fit the fixing through the rubber washer and top box and screw in to the back rest pad. Do not fully tight the fixing at this stage.
10. Tighten both fixings to **1 Nm**.



Warning

Never ride an accessory-equipped motorcycle (including those fitted with Triumph approved windscreens and luggage systems) at speeds above 80 mph (130 km/h).

The presence of accessories such as windscreens and luggage systems will cause changes in the stability and handling of the motorcycle. Failure to allow for changes in motorcycle stability may lead to loss of control or an accident.

Remember that the 80 mph (130 km/h) limit will be reduced by the fitting of non-approved accessories, incorrect loading, worn tyres, overall motorcycle condition and poor road or weather conditions.



Warning

If, after fitment of this accessory kit, you have any doubt about the performance of any aspect of the motorcycle, contact an authorised Triumph dealer and do not ride the motorcycle until the authorised dealer has declared it fit for use. Riding a motorcycle when there is any doubt as to any aspect of the performance of the motorcycle may result in loss of control of the motorcycle, leading to an accident.



Warning

Only operate this Triumph motorcycle at high speed in closed-course, on-road competition or on closed-course racetracks. High-speed operation should only be attempted by riders who have been instructed in the techniques necessary for high-speed riding and are familiar with the motorcycle's characteristics in all conditions.

High-speed operation in any other circumstances is dangerous and will lead to loss of motorcycle control and an accident.



Warning

The motorcycle must not be operated above the legal road speed limit except in closed-course conditions.

