

Fitting Instructions:

Tiger XR, Tiger XR_T, Tiger XR_x, Tiger XC, Tiger XC_A, Tiger XC_x,
Tiger 800, Tiger 800XC, Tiger 800 XC_x, Tiger 800 XC_A, Tiger 800 XR,
Tiger 800 XR_x, Tiger 800 XR_x LRH, Tiger 800 XR_T,
Tiger Explorer, Tiger Explorer XC, Explorer XR, Explorer XR_x, Explorer XR_T,
Explorer XC, Explorer XC_x, Explorer XC_A,
Tiger 1200 XR, Tiger 1200 XR_x, Tiger 1200 XR_x LRH, Tiger 1200 XC_x,
Tiger 1200 XR_T, Tiger 1200 XC_A

A9508163 A9500502 and A9500514

Thank you for choosing this Triumph genuine accessory kit. This accessory kit is the product of Triumph's use of proven engineering, exhaustive testing, and continuous striving for superior reliability, safety and performance.

Completely read all of these instructions before commencing the installation of the accessory kit in order to become thoroughly familiar with the kit's features and the installation process.

These instructions should be considered a permanent part of your accessory kit, and should remain with it even if your accessory-equipped motorcycle is subsequently sold.

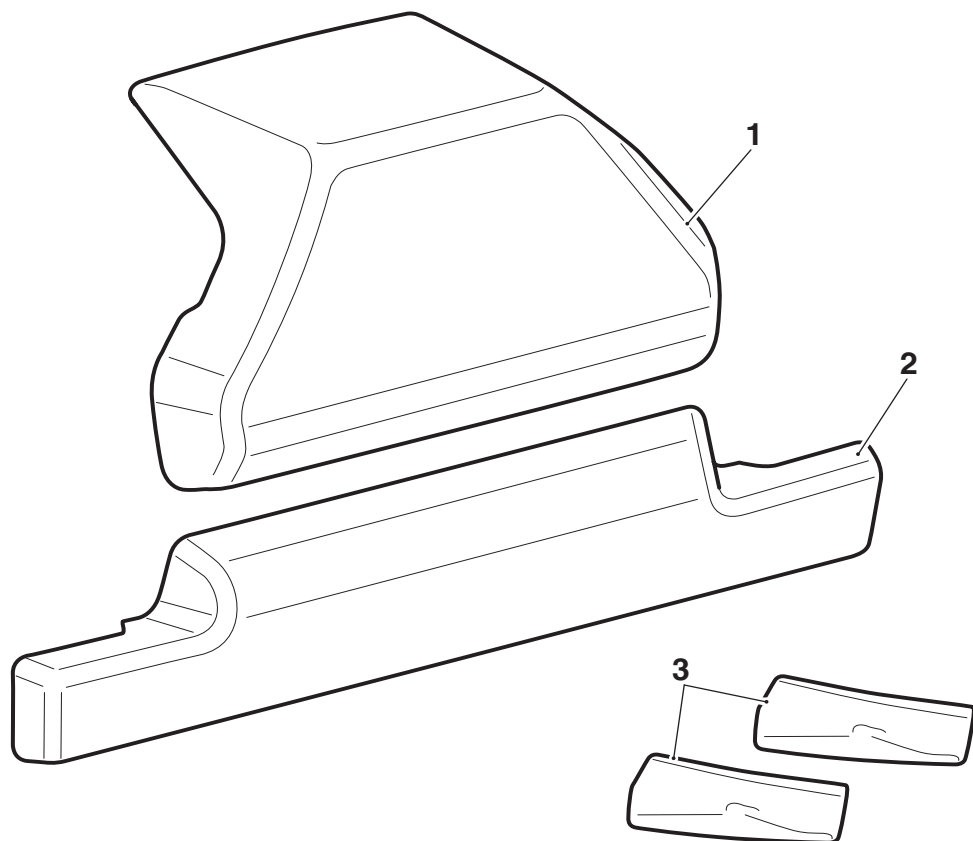

Parts Supplied:

- | | | | |
|------------------------|-------|------------------|-------|
| 1. Backrest, upper pad | 1 off | 3. Cleaning wipe | 2 off |
| 2. Backrest, lower pad | 1 off | | |



Warning

The accessory kits covered in this instruction are designed for use on specific models of Triumph motorcycle. The accessory kits and the models applicable are listed at the start of the instruction. They should not be fitted to any other Triumph model or to any other manufacturer's motorcycle. Fitting an accessory kit to a Triumph model not listed, or to any other manufacturer's motorcycle will affect the performance, stability and handling of the motorcycle. This may affect the rider's ability to control the motorcycle and could cause an accident.



Warning

Always have Triumph approved parts, accessories and conversions fitted by a trained technician of an authorised Triumph dealer. The fitment of parts, accessories and conversions by a technician who is not of an authorised Triumph dealer may affect the handling, stability or other aspects of the motorcycle's operation, which may result in loss of motorcycle control and an accident.



Warning

Throughout this operation, ensure that the motorcycle is stabilised and adequately supported on a paddock stand to prevent risk of injury from the motorcycle falling.

Note:

- Once the backrest has been fitted, it will become an integral part of the top box and cannot be removed.
- If fitted, remove the top box as described in its instructions.



Caution

Care must be taken when working on the top box. Damage to the top box surfaces may result from inadequate care while fitting the backrest pads.

- Lay the top box on a flat, clean and soft surface.

Upper Backrest Pad

Note:

- Read the warning notices printed on the cleaning wipe packet in the kit.
- Using the wipe provided, clean the mounting surface area of the top box.

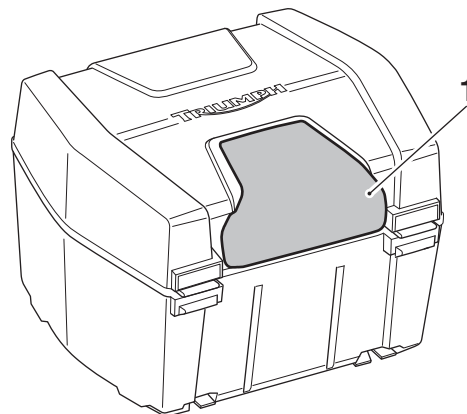

T0974_1

1. Cleaned area

- Align the upper pad to the top box lid as shown below.



T0974

1. Upper pad

5. Ensure that the pad is central and mark its position using suitable adhesive masking tape (not supplied in the kit).



Caution

When fitting self-adhesive parts, care must be taken to ensure positioning is correct and accurate. Once the adhesive has been attached to the mounting surface, there is no satisfactory method of removal and repositioning if incorrectly aligned. Initial bonding is instant, full bonding is achieved after 72 hours.

6. Remove the protective film strips from the rear of the upper pad.
7. Carefully locate the upper pad on to the top box to the previously marked position. Apply firm and even pressure to the entire upper pad to ensure a good bond is achieved.
8. Remove the masking tape.

Lower Backrest Pad

Note:

- Read the warning notices printed on the cleaning wipe packet in the kit.
9. Using the wipe provided, clean the mounting surface area of the top box.

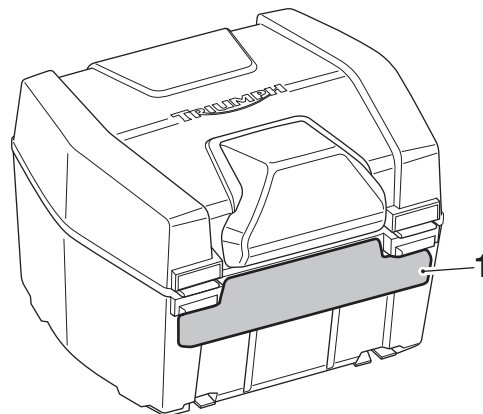

T0973_1

1. Cleaned area

10. Cut two pieces of masking tape approximately 10 mm long, using scissors. The ends must be cut square.
11. Mark a straight line on each length of tape at 6 mm, as shown below.

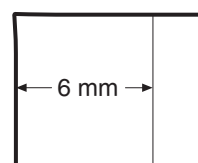
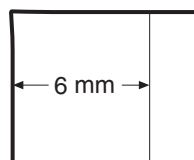

Markings on the Tape

12. Position the two pieces of masking tape onto the top box with the marked line level with the upper edge of the base as shown below.

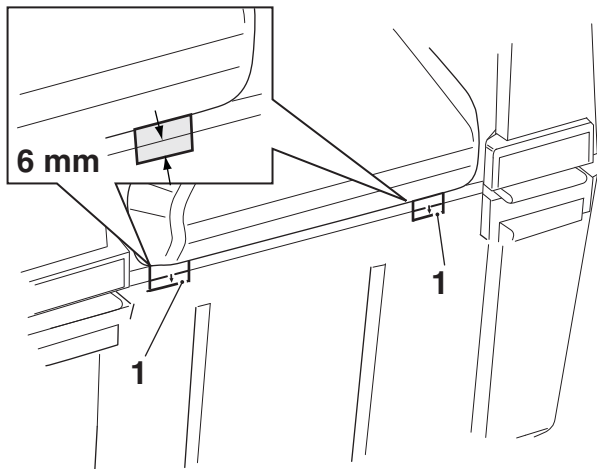

T0975

1. Masking tape



Caution

When fitting self-adhesive parts, care must be taken to ensure positioning is correct and accurate. Once the adhesive has been attached to the mounting surface, there is no satisfactory method of removal and repositioning if incorrectly aligned. Initial bonding is instant, full bonding is achieved after 72 hours.

13. Remove the protective film strips from the rear of the lower pad.
14. Carefully locate the lower pad on to the top box to the lower edge of the masking tape. Apply firm and even pressure to the entire lower pad to ensure a good bond is achieved.

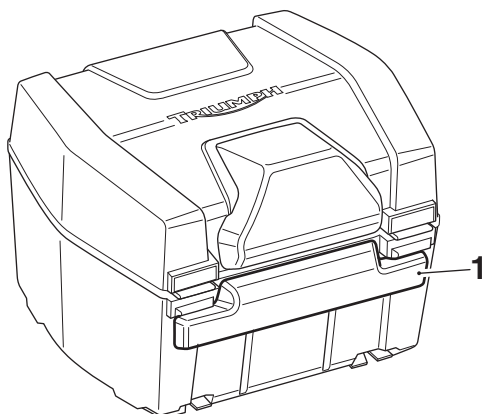

T0973

1. Lower pad

15. Remove the masking tape.



Warning

To prevent detachment of the top box while riding, after fitting always grasp the top box and pull firmly upwards and to the rear. If the top box is not correctly secured, it will detach from the sliding carriage. A loose or detached top box could cause loss of motorcycle control and an accident.

16. Refit the top box.
17. Check that the top box is securely locked to the sliding carriage.



Warning

Never ride an accessory-equipped motorcycle (including those fitted with Triumph approved windscreens and luggage systems) at speeds above 80 mph (130 km/h). The presence of accessories such as windscreens and luggage systems will cause changes in the stability and handling of the motorcycle. Failure to allow for changes in motorcycle stability may lead to loss of control or an accident.

Remember that the 80 mph (130 km/h) limit will be reduced by the fitting of non-approved accessories, incorrect loading, worn tyres, overall motorcycle condition and poor road or weather conditions.



Warning

Only operate this Triumph motorcycle at high speed in closed-course on road competition or on closed-course racetracks. High speed operation should only be attempted by riders who have been instructed in the techniques necessary for high speed riding and are familiar with the motorcycle's characteristics in all conditions.

High speed operation in any other circumstances is dangerous and will lead to loss of motorcycle control and an accident.



Warning

If, after fitment of this accessory kit, you have any doubt about the performance of any aspect of the motorcycle, contact an authorised Triumph dealer and do not ride the motorcycle until the authorised dealer has declared it fit for use. Riding a motorcycle when there is any doubt as to any aspect of the performance of the motorcycle may result in loss of control of the motorcycle, leading to an accident.